

A1

LICENSING AUTHORITY
 CERTIFIED BY
 DATE 03/03/2011

COPY

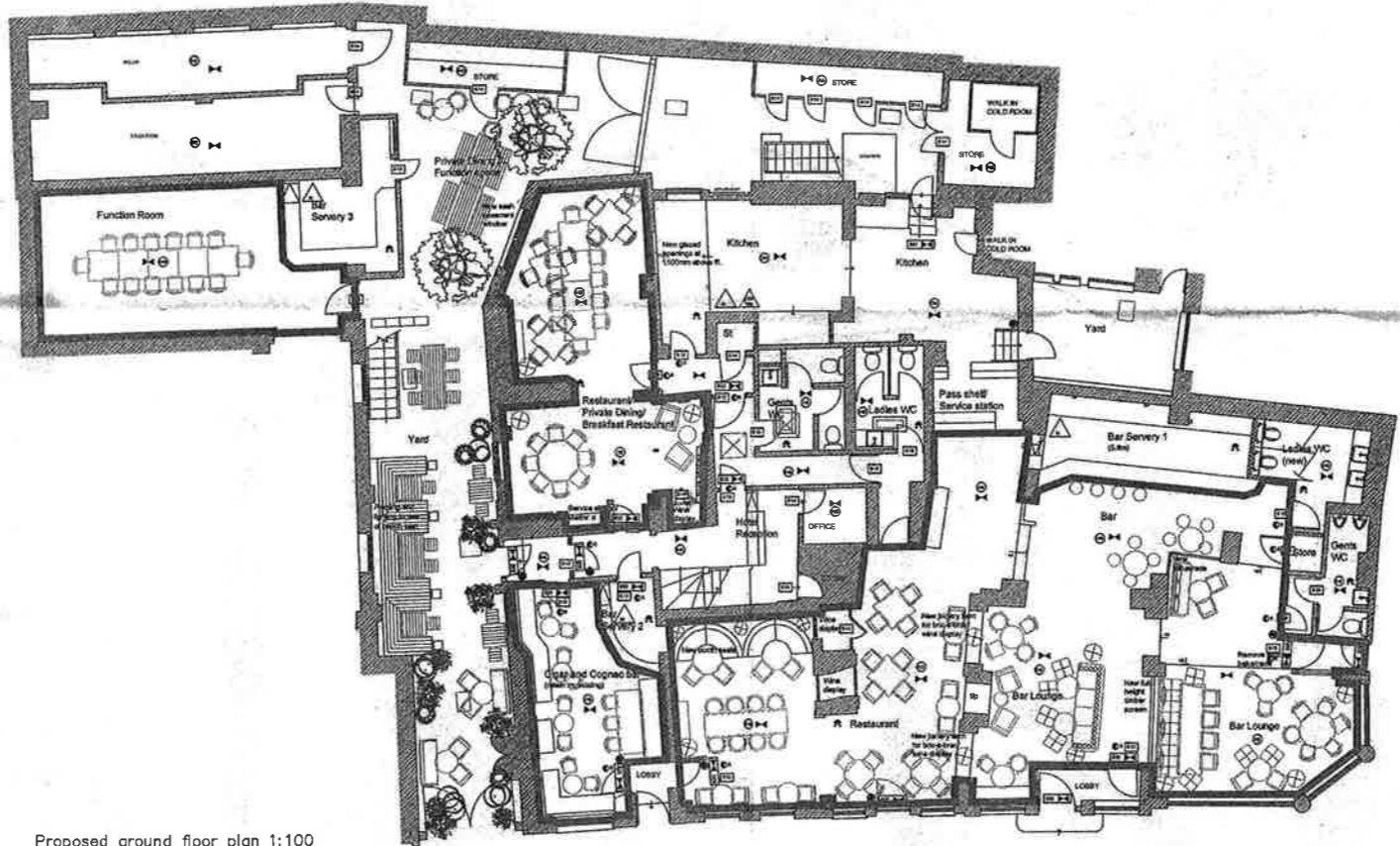

Proposed ground floor plan 1:100

Red line indicates boundary of licensed area

Note
 Consumption of alcohol and licensable activities take place anywhere within the premises. The position of any loose furniture is shown for diagrammatic purposes only. The location of fire equipment is shown on the date hereof but may be moved with the consent of the Fire Officer.

LEGEND

- FIRE SIGNAGE**
 (exact location to be agreed on site)
- [S22] Illuminated Fire Exit Sign
 - [S22] Illuminated Fire Exit Sign (directional)
 - [S14] Fire Door Keep Locked
 - [S13] Fire Door Keep Closed
 - [S14F80] Fire Door Keep Locked Fall safe open/digital control
 - [S20] Fire Escape Keep Clear
- DOOR TYPE KEY**
- S FD30S
 - S FD60S
 - S FD30
 - S FD60
 - Standard non-rated door
 - ☒ Area covered with a system of escape lighting that will illuminate the area upon failure of the normal lighting power supply to a sufficient standard to enable persons to leave the area safely. The escape lighting system should conform to the British Standard current at the time of its installation and a certificate to this effect kept with the fire certificate.
 - [FB] Doors which are provided with panic bolts. There must be a notice adjacent to fastening indicating method of opening (min.50mm high lettering)

- FIRE SAFETY EQUIPMENT**
 (exact location to be agreed on site)
- △ DP Fire extinguisher - Dry powder
 - △ CO Fire extinguisher - Carbon dioxide
 - △ W Fire extinguisher - Water
 - △ M Fire extinguisher - Multi purpose
 - △ M Fire blanket
 - ⊙ AD Automatic smoke detector
 - ⊙ AH Automatic heat detector
 - ⊙ HB Combined automatic heat/smoke detector
 - ⊙ Fire alarm call point
 - ⊙ Audible warning device

Legal Notice
 This drawing is the property of Tibbatts Kirkabel Ltd. Copyright is reserved by Tibbatts Kirkabel Ltd. No part of this drawing is to be reproduced or stored in a retrieval system without the written consent of Tibbatts Kirkabel Ltd. The drawing is to be used in accordance with the conditions of the contract. The drawing is to be used in accordance with the conditions of the contract.

TIBBATTSKIRKABEL
 Interior Designers and Architectural Consultants

Unit 214
 Fort Dunlop
 Birmingham
 B24 9PD
 Tel: +44 (0) 121 747 1111
 Fax: +44 (0) 121 747 1199
 info@tibbatts.com
 www.tibbatts.com

Client
 Urban and Country Leisure
 Greene King

Job Title
 The Kings Arms Hotel and Chapterhouse
 9-13 St Johns Street
 Salisbury
 Wiltshire SP1 2SB

Drawing Title
 Proposed Licensing Plans

Job Number
 1188

Scale
 1:100@A1

Date
 08.12.10

Drawn by
 AutoCAD/JT

Revised	Description	Date